

SoClean[®] 3+

REFERENCE GUIDE

- **Cleaning and Maintenance**
- **Moving and Storage**
- **Troubleshooting**
- **Warnings and Precautions**
- **Buttons/Indicator Icons and Lights**



Keep this Guide
with Your
SoClean 3+



**For Help with Setup or Questions
Related to Daily Use/Maintenance:
Call 866-501-3705**

SoClean 3+ is designed to be used by one user.

The SoClean 3+ should be used as an adjunct to reduce bacterial populations on certain compatible home use CPAP mask and ventilation hoses after cleaning.

You should not change or lessen the frequency of your hose and mask cleaning.

For a complete list of compatible accessories, please visit:
[SoClean.com/compatible-accessories](https://www.soclean.com/compatible-accessories)

During Use:

If you experience any respiratory or cardiac symptoms;

If you develop rash or acne where the mask touches your face:

Discontinue use of the SoClean 3+ and consult your healthcare provider.

Contact SoClean Customer Care before running your machine again.

If you notice a strong scent of ozone or other unfamiliar odor, or experience headache, cough or shortness of breath during your SoClean 3+ operation:

Leave the room for 4 hours from when your SoClean 3+ Cycle began.

Discontinue use of the SoClean 3+.

For more information, see “Troubleshooting” section in this Reference Guide or User Manual.



Refer to “Warnings” section in the User Manual.

CLEANING/MAINTENANCE

When the **Humidifier Tank** needs to be cleaned, the **Water Issue Icon**  will **flash orange** at the start of a cycle.

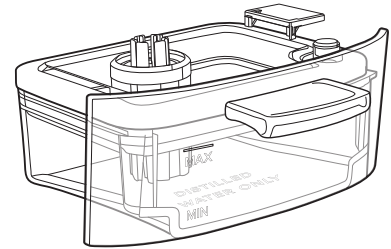

1

If it's time to clean your **Humidifier Tank**, press the button on the side of the **Drawer** to lift the **Drawer** up and remove the **Humidifier Tank**.

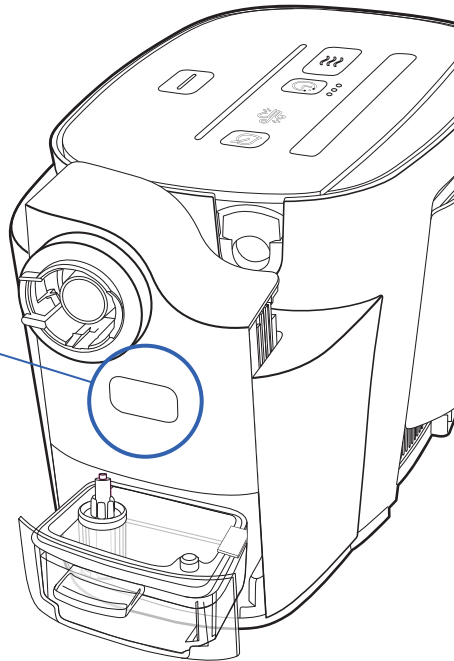

2

Remove the used **Wick** from the **Wick Inlet** and discard.

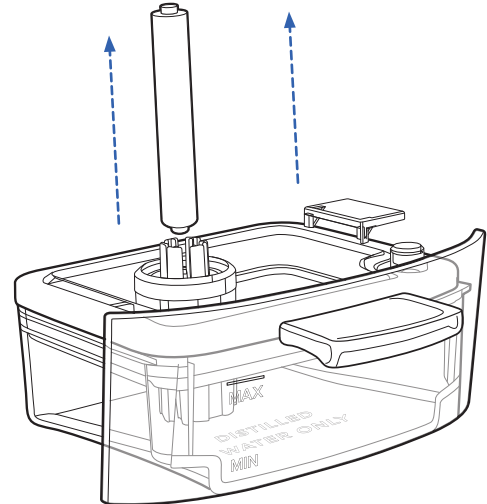

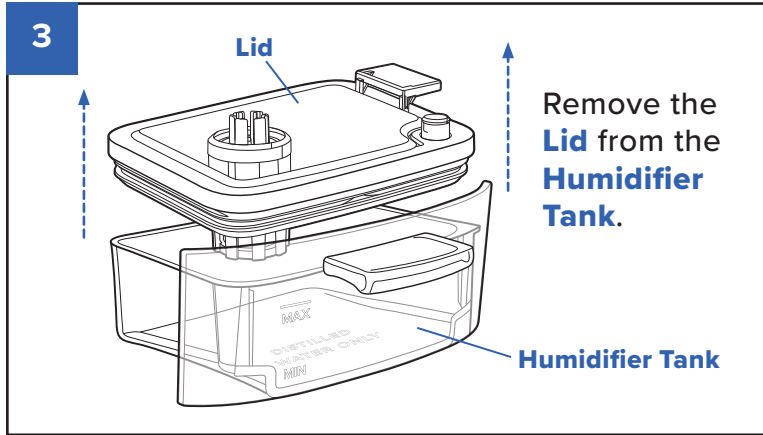

6

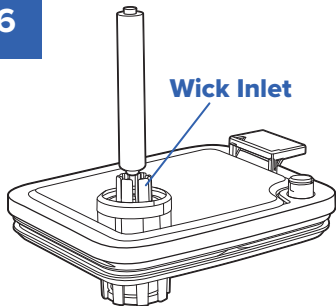

Remove a **Wick** from the bag. Guide the **Wick** into the **Wick Inlet** on the **Humidifier Tank Lid**, pushing down to ensure it is in place.

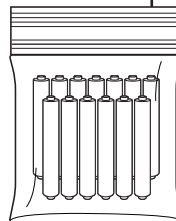

7

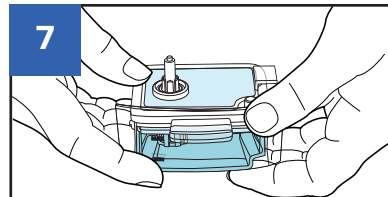

Replace the **Lid** on the **Humidifier Tank**.

Close firmly.

8

Press the button on the side of the drawer to lift the drawer up.

Install the **Humidifier Tank** into the **Drawer** of your SoClean 3+ by sliding it into the recess with the **Wick** facing up and on the left side.

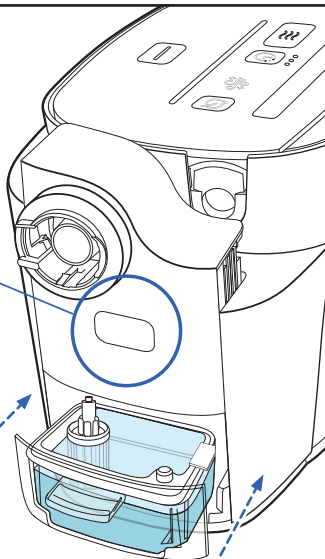

9

Press down on the **Drawer** until it latches into place.

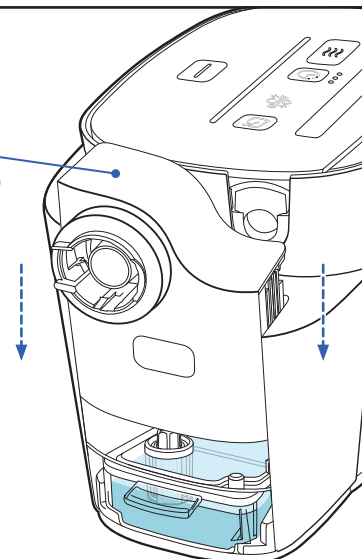

Replacing the Filter

Your SoClean 3+ is intended for once-daily use. Filters expire after 90 days.

The **Filter Issue Icon**  will flash **orange** to remind you that it is time to change your **Filter**.

The SoClean 3+ will no longer operate a Cycle if the Filter Issue Icon turns solid orange before the Filter is replaced.

A red triangle  will also be seen when the Filter requires replacement.

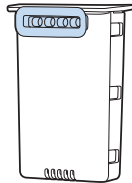

Pre-wash your CPAP Hose and Mask

Wash your CPAP hose and mask according to the sleep equipment manufacturer's recommended method and interval.

In addition, do this prior to using your SoClean 3+ for the first time or when replacing your hose and mask.

Refilling the Humidifier Tank

A Bacterial Reduction Cycle should not be run if there is no water in the Humidifier Tank.

Only use **distilled water** to fill the **Humidifier Tank** up to the MAX FILL line.



Cleaning your SoClean 3+

To clean your SoClean 3+, wipe the interior and exterior with a slightly damp cloth or CPAP wipes.

Do not submerge your SoClean 3+ in liquid or use chemical cleaners.

Do not put water inside your SoClean 3+.

Moving and Storing your SoClean 3+

If you need to move your SoClean 3+:

- Do not put the **Power Supply** into the **Hose & Mask Chamber**
- Remove CPAP hose and mask
- The **Humidifier Tank** can remain in place.

If you do not use or need to store your SoClean 3+ for more than three days:

- Remove and drain the **Humidifier Tank**
- Remove and discard the used **Wick**

Storage and Transport Conditions

Temperature: -4°F to 131°F (-20°C to +55°C)

Humidity: 15% to 95% non-condensing humidity

Pressure: 101.3kPa to 70kPa

[Sea level to 10,000' (3048m)]

Visible Cracks or Damage

⚠ WARNING: If your SoClean 3+ system is dropped, it may become damaged. Regularly inspect your SoClean 3+ for physical damage, such as cracks or broken structure, damaged gaskets, and cracks in the CPAP hose. Discontinue use if damage is detected and contact SoClean for assistance.

Reordering Parts or Accessories

To reorder supplies, contact your authorized reseller or visit [SoClean.com](https://www.soclean.com).

Your SoClean 3+ has been designed to work only with authentic SoClean 3+ Filters. You will not be able to operate your SoClean 3+ system with an inauthentic SoClean 3+ Filter.

The SoClean 3+ uses humidified ozone to reduce bacteria.

The ozone bacterial reduction process only achieves full reduction after your CPAP hose and mask have been through at least five SoClean 3+ Cycles.

Humidified ozone is passed through your hose and mask and once the cycle is complete, the ozone is converted back into oxygen.

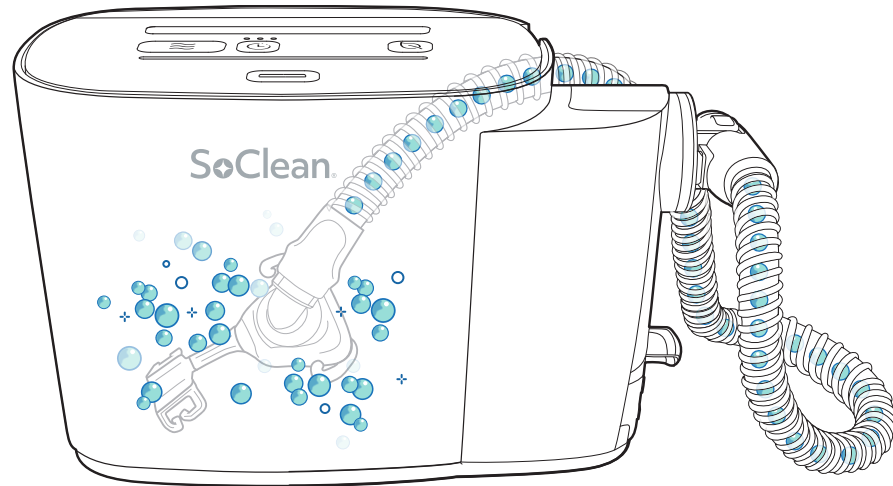

To learn more, see **“Learn About Ozone”** section in the User Manual

TROUBLESHOOTING

PROBLEM

POSSIBLE CAUSES

SOLUTIONS

There is a noticeable odor of ozone or unfamiliar odor, or you experience headaches/migraines, or symptoms such as cough or discomfort in your nose or throat during SoClean 3+ Cycle

Your SoClean 3+ may be damaged.

Leave the room for 4 hours from when your SoClean 3+ Cycle began. Discontinue use of your SoClean 3+. Contact SoClean Customer Care before running your machine again.

You or the person you care for notice feeling any cardiovascular or respiratory distress

You may be extremely sensitive to the smell of the oxidation process.

Discontinue use of the SoClean 3+. Consult your healthcare provider. Contact SoClean Customer Care.

You're developing a rash where the mask touches your face

Skincare or beauty products on the mask may not interact well with ozone.

.....

Regular hand washing of your hose and mask may not be taking place.

Discontinue use of your SoClean 3+ and consult your health care provider.

Contact SoClean Customer Care.

Regularly wash your hose and mask as instructed by the manufacturer.
Use unscented CPAP wipes to clean your mask before and after the SoClean 3+ Cycle.

After repeated use of your SoClean 3+, you experience headaches/migraines, or symptoms such as cough or discomfort in your nose or throat

Regular hand washing of your hose and mask may not be taking place.

.....

Skincare or beauty products on the mask may not interact well with ozone.

If symptoms persist, discontinue use of your SoClean 3+ and consult your health care provider.

Contact SoClean Customer Care.

Regularly wash your hose and mask as instructed by the manufacturer.
Use unscented CPAP wipes to clean your mask before and after the SoClean 3+ Cycle.

SoClean Customer Care: 866-501-3705

Full Troubleshooting Guide can be found in the User Manual.

WARNINGS

- ⚠ **WARNING:** Discontinue use and call your health care professional in the event that you experience any respiratory or cardiac symptoms.
- ⚠ **WARNING:** Keep away from children. Small parts contained in your device and its accessories may present a choking hazard to small children.
- ⚠ **WARNING:** When operating your SoClean 3+ per the instructions for use, if there is a noticeable scent of ozone or other unfamiliar odor or you experience headache, cough, or shortness of breath, leave the room for 4 hours from when your SoClean 3+ Cycle began. Discontinue use of your SoClean 3+. Contact SoClean Customer Care before running your machine again.
- ⚠ **WARNING:** If after repeated use of your SoClean 3+, you experience headaches/migraines, or symptoms such as cough or discomfort in your nose or throat, discontinue use and call your health care provider.
- ⚠ **WARNING:** Do not forcibly open your SoClean 3+ Lid before the Cycle completes.
- ⚠ **WARNING:** If the SoClean 3+ detects an internal error during the SoClean 3+ Cycle, it will terminate the Cycle and enter a locked state for a duration of two hours. This can not be overridden. Do not unplug the device. It is recommended that you keep a spare hose and mask on hand in the event that the device detects an error, and you are unable to remove your hose and mask from the SoClean 3+ in a timely manner.
- ⚠ **WARNING:** The SoClean 3+ should only be run with the Filter Door and Humidifier Drawer fully closed. The Filter Door and Humidifier Drawer should never be opened while a Cycle is running.
- ⚠ **WARNING:** Do not submerge your SoClean 3+ in water or use chemical cleaners on or in your SoClean 3+. Keep away from water sources, including rain, bathtubs, sinks, and pools. To clean, wipe inside and outside with a damp cloth or unscented CPAP wipes.

- ⚠ **WARNING:** Do not put liquids into your SoClean 3+ Hose & Mask Chamber.
- ⚠ **WARNING:** Do not disassemble or modify your SoClean 3+ or accessories.
- ⚠ **WARNING:** If your SoClean 3+ system is dropped, it may become damaged. Regularly inspect your SoClean 3+ for physical damage, such as cracks or broken structure, damaged gaskets, and cracks in the CPAP hose. Discontinue use if damage is detected and contact SoClean for assistance.
- ⚠ **WARNING:** Strangulation hazard. To avoid risk of tripping or strangulation, place your SoClean 3+ along with all cords, and hoses out of the way of any area you may walk.
- ⚠ **WARNING:** Use of this equipment adjacent to or stacked with other equipment should be avoided because it could result in improper operation. If such use is necessary, this equipment and the other equipment should be observed to verify that they are operating normally.
- ⚠ **WARNING:** Use of accessories, transducers and cables other than those specified or provided by the manufacturer of this equipment could result in increased electromagnetic emissions or decreased electromagnetic immunity of this equipment and result in improper operation.
- ⚠ **WARNING:** Portable RF communications equipment (including peripherals such as antenna cables and external antennas) should be used no closer than 30 cm (12 inches) to any part of the SoClean 3+, including cables specified by the manufacturer. Otherwise, degradation of the performance of this equipment could result.
- ⚠ **WARNING:** Do not disconnect your CPAP hose from the Hose Port while a SoClean 3+ Cycle is in progress.

PRECAUTIONS

Contraindications for Use: Persons with underlying lung diseases, such as asthma and chronic obstructive pulmonary disease (also known as COPD, which includes emphysema and chronic bronchitis), and those with cardiovascular disease may be sensitive to ozone and should consult with their health care provider before using this product. Safety in pregnant or breastfeeding women and children under the age of 22 have not been established. Consult with your health care professional before using this product.

- ⚠ **CAUTION:** Do not place any flammable or ignitable items on top of your SoClean 3+. Do not use in explosive air environments, oxygen-rich environments, near gas vapors, or other flammable agents, etc.
- ⚠ **CAUTION:** Discontinue use of your SoClean 3+, consult your health care professional, and contact SoClean Customer Care if acne or a rash develops along the mask contact line.
- ⚠ **CAUTION:** Ensure all hoses are free of kinks prior to operating the SoClean 3+.
- ⚠ **CAUTION:** Rest the flexible part of the CPAP hose, not the rigid mask connector, in the Hose Slot to ensure a proper seal.
- ⚠ **CAUTION:** Inspect your SoClean 3+ Lid and Hose Gaskets for visible damage before operating a SoClean 3+ Cycle.
- ⚠ **CAUTION:** Do not share a SoClean 3+ between CPAP users. Your SoClean 3+ is designed for only one user and a single CPAP mask and hose at a time.
- ⚠ **CAUTION:** In the event of loss of power, rerun the entire SoClean 3+ Cycle to make sure the sleep equipment hose and mask have been maintained properly.

- ⚠ **CAUTION:** Wash your CPAP hose and mask according to the manufacturer's recommended method and interval. Use your SoClean 3+ as an adjunct to reduce bacterial populations on certain compatible home use CPAP mask and ventilation hoses after cleaning.
- ⚠ **CAUTION:** Do not use incompatible materials in the SoClean 3+ such as memory foam, natural rubber, or nylon. Headgear often contains incompatible materials for your SoClean 3+. Remove headgear before placing mask in Hose & Mask Chamber. SoClean 3+ has been tested for use with ResMed Mirage™ FX (nasal mask), ResMed AirFit™ P10 (mask), ResMed ClimateLineAir™ (tubing), and ResMed SlimLine™ (tubing) for ResMed AirSense™ 10 CPAP device. The safe use of SoClean 3+ with any other respiratory devices or accessories has not been established. For a complete list of compatible accessories, please visit SoClean.com/compatible-accessories.
- ⚠ **CAUTION:** Ensure there are no obstructions to the filter exhaust. Keep the area behind your SoClean 3+ clear of clutter and soft objects.

NOTE: The SoClean 3+ should be used as an adjunct to reduce bacterial populations on certain compatible home use CPAP mask and ventilation hoses after cleaning. While normal everyday use of CPAP hoses and masks may result in discoloration of these accessories over time, use of hoses and masks with the SoClean 3+ may impact discoloration of your hose or mask. Continued cleaning of your hose and mask as directed by the hose and mask manufacturer is important. Please see our warranty section for further information related to hose and mask accessory warranties.

Buttons

There are 4 buttons on the Lid that are used to operate your SoClean 3+.

There is no power button on your SoClean 3+.

Your SoClean 3+ enters a low-power “sleep” mode when not in use and fully powers when any button on the Lid is pushed.

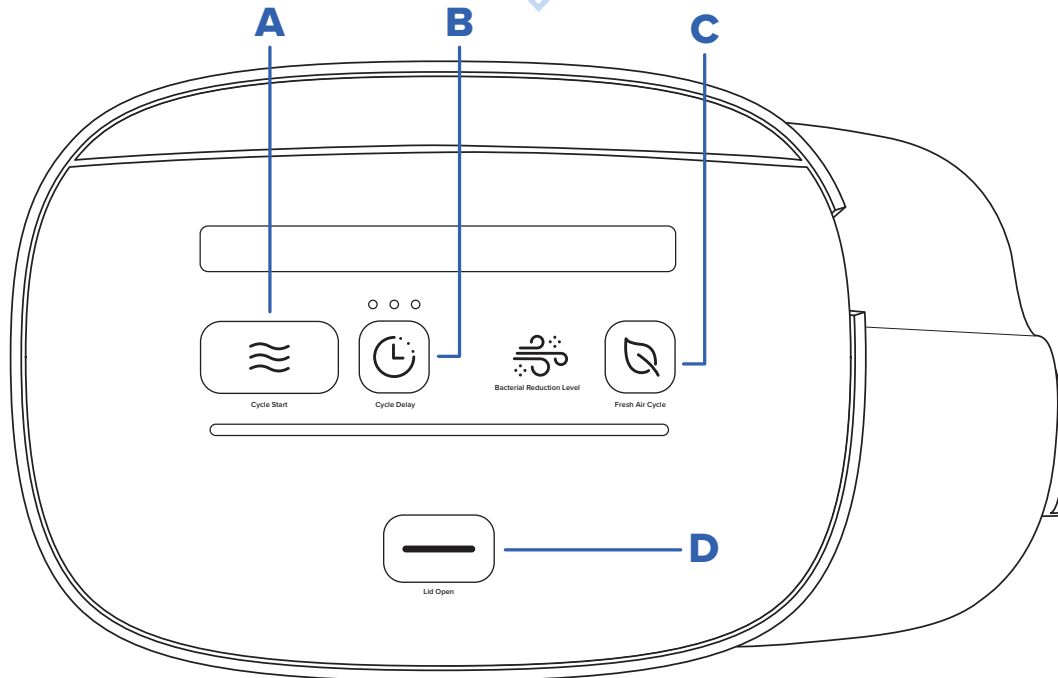

Buttons illuminate **blue** when any one is pressed to help with visibility in low-light conditions.



Cycle Start Button

Push this button to immediately start the bacterial reduction process. The SoClean 3+ Cycle takes about 90 minutes to complete.

NOTE: Cycles cannot be run back to back without first disconnecting and reconnecting the CPAP Hose to the Hose Port.



Fresh Air Cycle Button

Run air through the system to freshen your hose and mask by pressing this button. The Fresh Air Cycle takes about 5 minutes to complete. You can only run 3 Fresh Air Cycles in a row before you must run a SoClean 3+ Cycle.

NOTE: The Fresh Air Cycle does not reduce bacteria in your hose and mask.

Your hose must be connected to the Hose Port, and your mask and hose must be in your SoClean 3+ Chamber with the Lid closed to run any Cycle.



Cycle Delay Button

Use to set a 2, 4, or 8 hour delay to the start of your SoClean 3+ Cycle. See “Setting a Delayed Cycle Start” section in the User Manual.

NOTE: The system automatically returns to the default setting of **No Delay** after each use.



Lid Open Button

Opens your SoClean 3+ Lid when the device is connected to power. This button can also be used to cancel an active SoClean 3+ Cycle by pressing and holding for 5 seconds.

NOTE: If canceling a Cycle, your SoClean 3+ Lid cannot be opened immediately. It will take about 15 minutes before the - Bacterial Reduction Level icon  lights up and you can open your SoClean 3+.

Indicator Icons/Lights

There are 8 indicator icons that light up to communicate with you. The indicator icons will light up if attention is needed.

The three round lights, Cycle Progress Bar and buttons also all light up.

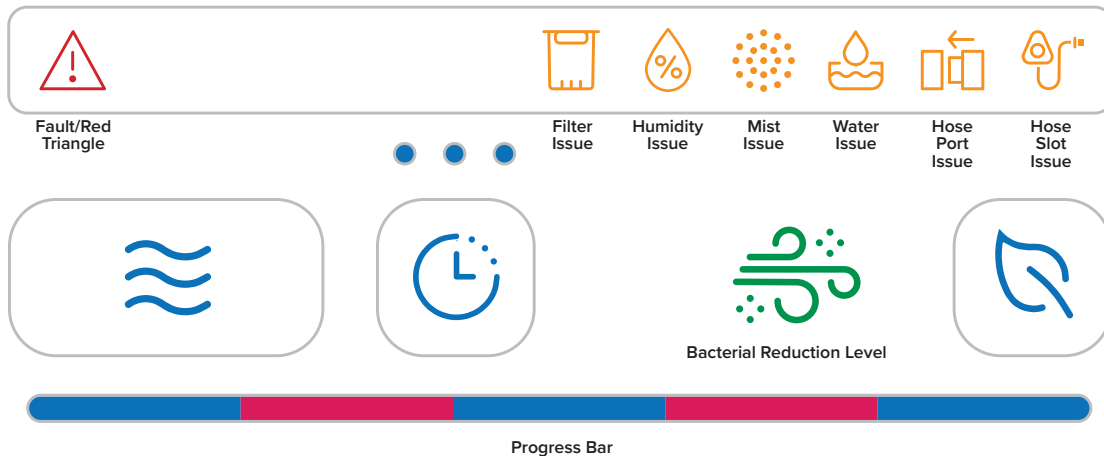

Bacterial Reduction Level



Solid Green - Indicates that a SoClean 3+ Cycle is complete. Optimal bacterial reduction has been reached. Your SoClean 3+ Lid can be opened.



Solid Orange - Indicates that a SoClean 3+ Cycle is complete and your SoClean 3+ is safe to open. Your hose and mask are ready to use but may not have reached the optimal bacterial reduction level. If this occurs after your next SoClean 3+ Cycle, contact Customer Care.

Solid Orange and Fresh Air Cycle Button  are lit. Fresh Air Cycle is complete. The desired bacterial reduction level has not been achieved.

Solid Orange and Solid Red  - Call SoClean Customer Care.

Fault/Red Triangle



Solid Red - Indicates when your SoClean 3+ has detected an internal issue. See troubleshooting guide.

Mist Issue



Flashing Orange - Indicates that there was an internal issue with Humidity during the Bacterial Reduction Cycle. You will see a Solid Orange Bacterial Reduction Level at the end of the cycle. Your tank may need more water or your wick may be missing. If this occurs after your next SoClean 3+ Cycle, contact Customer Care.

Solid Orange + Solid Red  - Call Customer Care.

Water Issue



Flashing Orange - Indicates that it is time to clean your Humidifier Tank and replace your Wick. See Tank maintenance instructions.

Solid Orange - Indicates that the Humidifier Tank is missing or the drawer is open. If the tank is installed, check the drawer by opening it and pressing it back down into place.

Filter Issue



Flashing Orange - Indicates that it is time to order a new Filter. From the time it begins to flash orange, you have 30 days or 30 uses (whichever comes first) to replace the Filter. You can still use your SoClean 3+ as normal.

Solid Orange - The Filter is missing. The Filter Door may be open. If a Filter is installed, check your filter door and open/close it securely.

Solid Orange + **Solid Red** ⚠️ - The Filter is expired. The Filter must be replaced before another cycle can be run.



Humidity Issue

Flashing Orange - Indicates that there was an internal issue with Humidity during the Bacterial Reduction Cycle. You will see a Solid Orange Bacterial Reduction Level at the end of the cycle. Your tank may need more water or your wick may be missing. If this occurs after your next SoClean 3+ Cycle, contact Customer Care.

Solid Orange + **Solid Red** ⚠️ - Call Customer Care.

Hose Port Issue



Flashing Orange - Error detecting the hose. Disconnect and reconnect hose to Hose Connection Port.

Solid Orange -

The hose is not connected to the Hose Connection Port.

Hose Slot Issue



Solid Orange - Indicates that your CPAP hose is not present or detected when your SoClean 3+ Lid is closed.

Flashing Orange - Error detecting the hose. Open and close SoClean Lid with hose and mask installed to continue.

2, 4, 8 Hour Cycle Delay



Flashing Blue

Indicates that the Cycle Delay can be changed by pressing the **Cycle Delay** button (⏸). See “Setting a Delayed Cycle Start” section for details.

NOTE: Your hose and mask must be installed with the Lid closed to modify and activate the Cycle Delay.

2, 4, 8 Hour Cycle Delay

○○○ Solid Blue

Indicates if a Cycle Delay has been programmed.

Three indicator lights are provided.

One light illuminated ●○○ = 2-hour delay selected

Two lights illuminated ●●○ = 4-hour delay selected

Three lights illuminated ●●● = 8-hour delay selected

No lights illuminated ○○○ = no cycle start delay selected
(default)

Cycle Progress Bar

▬ Progressive Blue

Gradually turns **blue** from left to right to show the progress of a SoClean 3+ Cycle or Fresh Air Cycle.

▬ Flashing Blue

A Cycle cancellation is in progress.

▬ Solid Red

Indicates that an active SoClean 3+ Cycle has been interrupted (example: temporary loss of power).



Copyright © 2011-2026

**SoClean® is a registered trademark of SoClean, Inc.
1 Vose Farm Road, Peterborough, NH 03458, U.S.A.
Patent: SoClean.com/patents**

Issue Date: 02/2026