

SoClean™ AIR PURIFIER

Featuring Celios® Advanced Air Purification Technology

User Manual

Model: G200

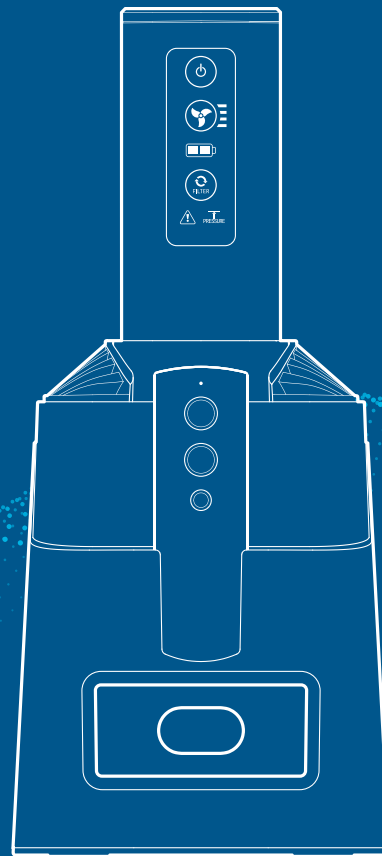

THANK YOU

For purchasing your SoClean Air Purifier

Our mission is to bring pure air to those most susceptible to poor air quality.

The SoClean Air Purifier is designed for individual rooms and personal spaces. With its portable, lightweight design, the SoClean Air Purifier, featuring Celios Advanced Air Purification Technology, removes allergens and mold and eliminates up to 99.99999% of viruses and bacteria.* Its ultra-fine purification system captures particulate matter down to 10 nanometers in size and is up to 3,000 times more efficient than HEPA standards.

EASY TO PUT TOGETHER. NO TOOLS REQUIRED!

If you have any questions, please contact our Customer Care team at 866-501-3705 or info@soclean.com.

To order replacement parts, visit [SoClean.com/air](https://www.soclean.com/air).

*Bacteria and virus testing includes *Staphylococcus aureus* and MS2 Φ X 174 bacteriophage. To see data on allergens, viruses, bacteria, mold and dust, visit [SoClean.com/air-test](https://www.soclean.com/air-test).

READ AND SAVE THESE INSTRUCTIONS

Table Of Contents

PACKAGE CONTENTS	6
• SOCLEAN AIR PURIFIER PRODUCT SPECIFICATIONS	7
• IMPORTANT SAFETY INFORMATION	8
WHERE TO PLACE YOUR SOCLEAN AIR PURIFIER	10
SETTING UP YOUR SOCLEAN AIR PURIFIER	12
• INSTALLING THE AIR FILTERS	12
• INSTALLING THE LITHIUM ION SMART BATTERIES	17
• SETTING UP THE REMOTE CONTROL	22
REMOTE CONTROL SETTINGS	25
CORE PANEL DESCRIPTIONS	28
CLEANING YOUR SOCLEAN AIR PURIFIER	29
ALARMS & NOTIFICATIONS	30
TROUBLESHOOTING	32
SOCLEAN LIMITED WARRANTY	34

SoClean Air Purifier Package Contents









1. Core
2. Main Stand
3. Mini Stand
4. Core Filter
5. Carbon Filters
6. Pre Filters
7. Lithium Ion Smart Batteries
8. Remote Control
9. Power Adapter
10. AAA Batteries*
11. User Manual*

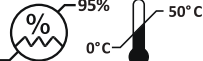

*Not shown

6 Featuring Celios Advanced Air Purification Technology

SoClean Air Purifier Product Specifications

Power Requirements:	DC input 15V, 4A ; Power brick 100-240V, 50-60Hz, 1.5A
EPA Est.	96509-NH-1
AC Power Usage:	Idle - 0.6W, Speed 1 - 2.5W, Speed 2 - 3.8W, Speed 3 - 6.5W, Speed 4 - 22W
Dimensions (with main stand):	14.125" X 5.75" X 10.5"
Dimensions (with mini stand)	12.375" X 4" X 9.5"
Weight:	Core Unit w/out batteries: 3lb 5oz Core Unit w/ batteries: 4lb Main Stand: 3lb 10oz Mini Stand: 4 oz
Noise Level (dBA):	In Main Stand : Speed 1 - 34, Speed 2 - 46, Speed 3 - 56, Speed 4 - 64 In Mini Stand : Speed 1 - 36, Speed 2 - 52, Speed 3 - 62, Speed 4 - 71
3 Stage Filtration:	Carbon Filter, Pre Filter and Core Filter
Filter Life Expectancy:	24 Hour Use - Pre Filter: 2 months, Carbon Filter: 2 months, Core Filter: 4 months 12 Hour Use - Pre Filter: 4 months, Carbon Filter: 4 months, Core Filter: 8 months
Certifications and Symbols:	     CARB CERTIFIED Meets California ozone emissions limit.   

Featuring Celios Advanced Air Purification Technology

READ AND SAVE THESE INSTRUCTIONS

IMPORTANT SAFETY INFORMATION

WARNING: To reduce the risk of fire or electric shock, do not use this fan with any solid-state speed control device.

WARNING: Unplug or disconnect the appliance from the power supply before servicing.

WARNING: The appliance is only to be used with the power supply unit provided and it must only be supplied at safety extra low voltage, corresponding to the marking on the appliance.

WARNING: NOT SUITABLE FOR USE WITH SOLID-STATE SPEED CONTROLS.

DO NOT operate any fan with a damaged cord or plug. Discard fan or return to an authorized service facility for examination and/or repair.

DO NOT run cord under carpeting. Do not cover cord with throw rugs, runners or similar covers. Do not route cord under furniture or appliances. Arrange cord away from the traffic area and where it will not be tripped over.

KEEP OUT OF REACH OF CHILDREN.

DO NOT operate if the power cord is damaged. Only plug the power cord into a standard electrical outlet.

DO NOT use outdoors.

DO NOT immerse the SoClean Air Purifier in liquid and do not handle the SoClean Air Purifier with wet hands.

DO NOT insert a finger or foreign object into the airflow openings.

DO NOT use the SoClean Air Purifier in toxic or explosive environments or where flammable or combustible gases are present.

This device complies with Part 15 of the FCC Rules. Operation is subject to the following two conditions:

(1) This device may not cause harmful interference, and (2) This device must accept any interference received, including interference that may cause undesired operation.

CAUTION: The user is cautioned that changes or modifications not expressly approved by the party responsible for compliance could void the user's authority to operate the equipment.

This device complies with part 15 of the FCC Rules and Innovation, Science and Economic Development Canada RSS-210.

Operation is subject to the following two conditions:

(1) This device may not cause harmful interference, and (2) this device must accept any interference received, including interference that may cause undesired operation.

NOTE: This equipment has been tested and found to comply with the limits for a Class B digital device, pursuant to part 15 of the FCC and ISED Rules. These limits are designed to provide reasonable protection against harmful interference in a residential installation. This equipment generates, uses and can radiate radio frequency energy and, if not installed and used in accordance with the instructions, may cause harmful interference to radio communications. However, there is no guarantee that interference will not occur in a particular installation. If this equipment does cause harmful interference to radio or television reception, which can be determined by turning the equipment off and on, the user is encouraged to try to correct the interference by one or more of the following measures:

- Reorient or relocate the receiving antenna.
- Increase the separation between the equipment and receiver.
- Connect the equipment into an outlet on a circuit different from that to which the receiver is connected.
- Consult SoClean Customer Care for help.

FCC/ISED Caution: Changes or modifications not expressly approved by the party responsible for compliance could void the user's authority to operate the equipment.

FCC/ISED Caution: This equipment complies with FCC/IC RSS-102 radiation exposure limits set forth for an uncontrolled environment. To maintain compliance with the FCC and IC RF Exposure guidelines, place the unit at least 20 cm away from nearby persons.

User Servicing Instructions:

Grasp plug and remove from the receptacle or other outlet device. Do not unplug by pulling on cord.

Prior to cleaning or other maintenance, the appliance must be disconnected from the power outlet.

Replacement Battery Guidelines:

- Batteries must be installed in accordance with SoClean guidelines.
- Only use certified rechargeable lithium ion Celios Smart batteries.
- Do not use non-rechargeable batteries.
- Worn-out or damaged batteries must be disposed of properly at a qualified recycling center.

- If you have a leaky battery, remove in a well-ventilated area. Wear household gloves and glasses. Using a toothbrush or cotton swab, remove battery leakage from the electrical contacts. Make sure the electronic device is completely dry before trying a new battery.

Disposal and Recycling instructions for Battery:

- A battery operated air purifier with integral batteries or a separate/detachable battery pack shall be recharged only with the specified charger for the battery. A charger that may be suitable for one type of battery may create a risk of fire when used with another battery.
- Use battery-operated fan only with specifically designated battery pack. Use of any other batteries may create a risk of fire.
- When battery pack is not in use, keep it away from other metal objects, such as paper clips, coins, keys, nails, screws, or other small metal objects that can make a connection from one terminal to another. Shorting the battery terminals together may cause sparks, burns, or fire.
- Do not incinerate this air purifier, even if it is severely damaged. The batteries may explode in a fire. Dispose of the air purifier in accordance with the following instructions:

Instructions for Disposal of the Product:

Proper disposal of this product helps prevent waste and potential negative effects on the environment and human health. For detailed recycling information, please contact your local domestic waste disposal service or the store that purchased this product.

Where to place your SoClean Air Purifier

The SoClean Air Purifier is designed to purify air in small rooms* or personal spaces, such as your bedroom, office, or car to create a zone of purified air around you. Use in larger rooms, may require longer run time to achieve desired purification*. The SoClean Air Purifier comes with a Main Stand and a Mini Stand. You can easily move the Core between its two stands.

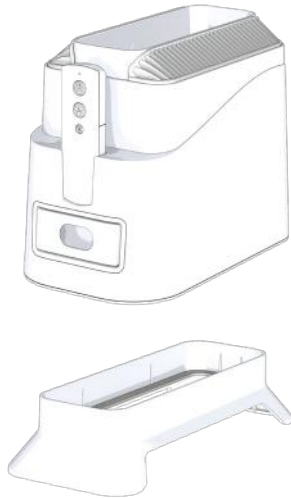

Main Stand

The Main Stand includes a Carbon Filter that removes Volatile Organic Compounds (VOCs), which include gases and odors, such as those emitted from common household products. The Main Stand provides sound dampening and offers higher fan output when using the power adapter.

Mini Stand

The Mini Stand offers convenience and portability to easily dock your Core air purifier with a small footprint, providing an unobstructed air flow at the Core air intake when the Core is not used with the Main Stand.

Once the batteries are charged, the SoClean Air Purifier can be used anywhere you choose for up to 24 hours unplugged. You can place the unit on almost any flat surface, with or without a stand. When you are not using a stand, just be sure to place the SoClean Air Purifier on its side, so the honeycomb grill on the bottom of the Core is not obstructed and is free to pull in air.

Featuring Celios Advanced Air Purification Technology



Setting up your SoClean Air Purifier

STEP 1:

INSTALLING THE AIR FILTERS

The SoClean Air Purifier uses three different powerful air filters. All are colored blue for easy identification. You will need to order a replacement Filter Kit about every 8 months.

Each kit contains one Core Filter, two Carbon Filters, and two Pre Filters. To order a SoClean Air Purifier Filter Kit, please visit our website at SoClean.com/air.



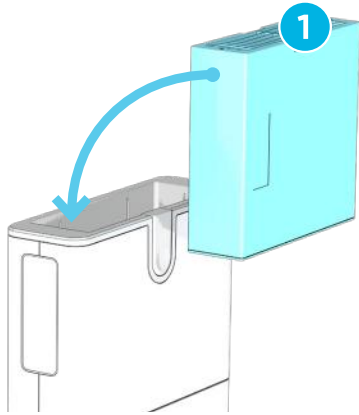

Install the Core Filter

The SoClean Air Purifier comes with one Core Filter. This filter captures ultrafine particulates down to 10 nanometers in size. You will need to replace your Core Filter about every 8 months.

1. Slide the Core Filter into the Core with the grill facing up.
2. The filter clicks into place when properly installed.

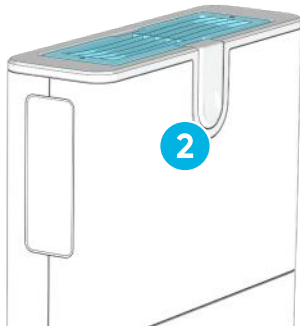

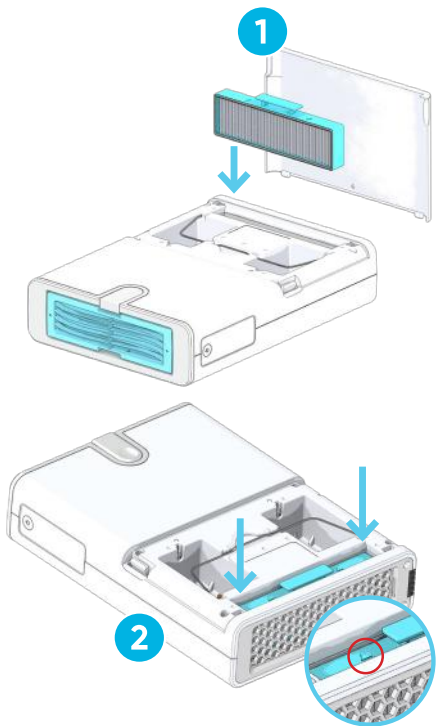

Install the Pre Filter

The SoClean Air Purifier comes with two Pre Filters. You will install one and save one for future use. The Pre Filter is made from material often found in HVAC systems, specifically designed to capture large airborne particles, such as dust, pollen, and pet dander. You will need to replace your Pre Filter about every four months.

1. Turn the Core over, so the Celios logo is facing down. Remove the back panel at the bottom of the unit.
2. Slide the Pre Filter into place with the arrows pointing toward the top of the Core. Make sure to push the Pre Filter completely into the Core so that the back panel can fully close.

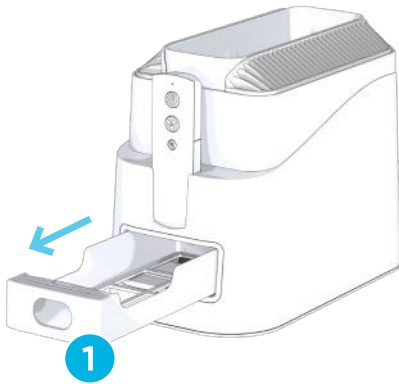

Install the Carbon Filter

The SoClean Air Purifier comes with two activated granular Carbon Filters. You will install one now and save one for future use. The Carbon Filter removes gases, odors, and VOCs emitted from common household products. You will need to replace your Carbon Filter about every four months.

Important: The Core should be removed from the Main Stand when installing or removing the Carbon Filter.

1. Remove the Carbon Filter tray from the Main Stand.

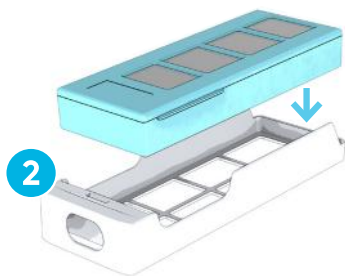

2. Place the Carbon Filter into the tray as shown.
3. Slide the tray back into position in the Main Stand.

Note: The Carbon Filter tray will click when fully installed.

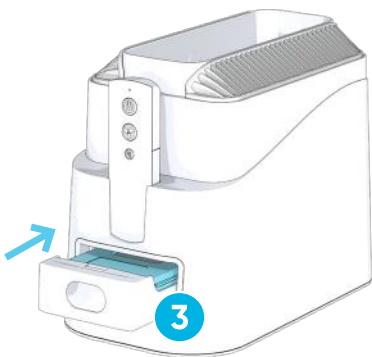

STEP 2:

INSTALLING THE LITHIUM ION SMART BATTERIES

The SoClean Air Purifier runs on either outlet power or Lithium Ion Smart Batteries, which are included with your purchase. These batteries are hot swappable, which means you can remove either of them without shutting down or interrupting air purification.

The expected life of each Celios Lithium Ion Smart Battery is approximately 2–3 years. To purchase additional batteries, please visit our website at SoClean.com/air.

Featuring Celios Advanced Air Purification Technology



Note: you can run the SoClean Air Purifier without batteries by plugging the Main Stand or Core into a powered electrical outlet.

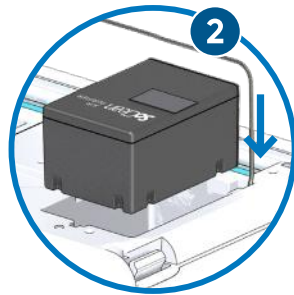
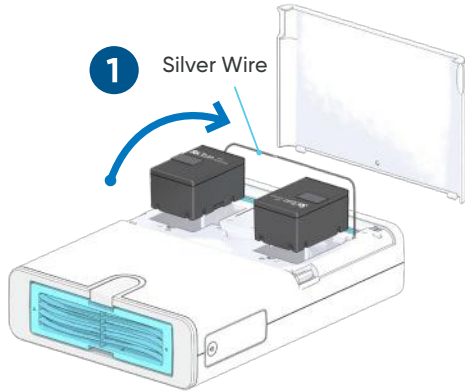

Install Batteries into the Core

1. There are two slots for the Lithium Ion Smart Batteries above the Pre Filter you just installed. Pull the silver wire and rotate it upwards.
2. Take one Lithium Ion Smart Battery and align the battery slots to the slots within the unit. The unit will beep when the first battery is correctly installed.

Take the second battery and do the same. Note you will not hear a beep with the second battery. Also, note battery label orientation may not reflect illustration.

Place the silver wire back into position and replace the back cover onto the Core unit.

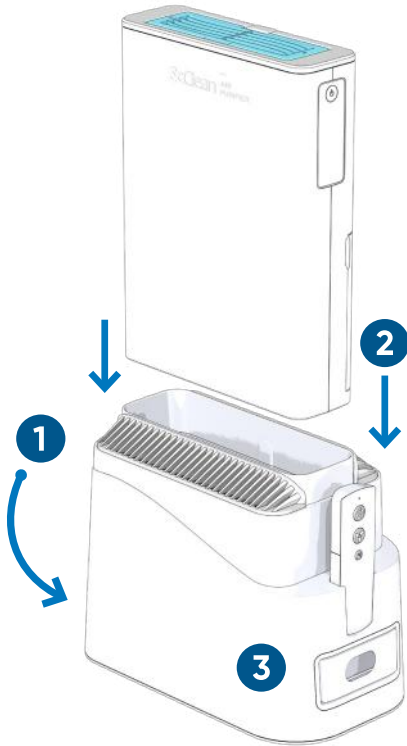

Dock the Core in the Main Stand

1. Plug the Power Adapter into the Main Stand and then to a powered electrical outlet.
2. Slide the Core into the Main Stand.
The control panel on the Core will be facing the same side as the Remote.
3. When you correctly dock the Core in the Main Stand, the unit will beep (whether you have AC power or not). If the Core is not properly installed, it will not beep and will not sit properly within the Main Stand.

You may remove the tape straps from the air intake vents.

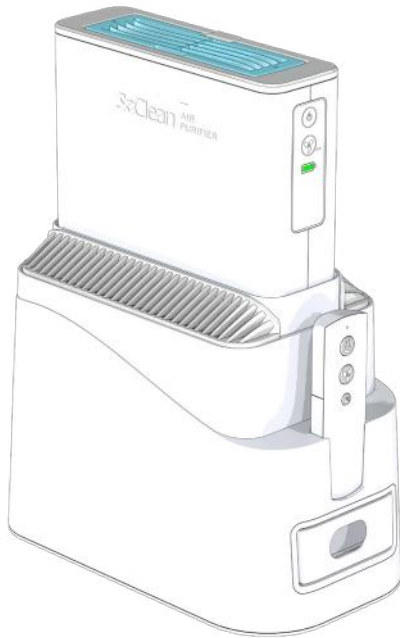

Charge the Batteries

1. After turning on the Core, the battery life indicator  on the control panel shows that the batteries are charging. While the battery is charging, the light will change from red, to yellow, to green. When the batteries are fully charged or when there are no batteries in the Core, the battery life indicator light will turn off.
2. You can also charge the batteries outside of the Main Stand by plugging the Power Adapter directly into the Core.

Note: The SoClean Air Purifier can operate:

- On one or both of its batteries
- Without batteries and power provided by the Power Adapter

Charging the Batteries the First Time

Properly charging the batteries will allow maximum runtime and battery life. The following procedure should be followed on the first charge of any new batteries.

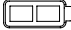
1. After inserting batteries, connect the Core with the supplied power adapter. The Core can be docked in the Main Stand or plugged in directly.
2. Allow the batteries to charge until full  . You may run the SoClean Air Purifier on any setting while charging.
3. Turn the unit on to Speed 1 and remove the power adapter plug.
4. Allow the unit to fully discharge and power off. This operation can take up to 30 hours.
5. Fully charge the unit again per Steps 1 and 2 above. The batteries are now properly charged for maximum performance.

This procedure can be repeated if the battery life is lower than expected. If this procedure fails to increase battery life, contact Customer Care at 866-501-3705 or info@soclean.com.

STEP 3:

SETTING UP THE REMOTE CONTROL

The SoClean Air Purifier uses a  Bluetooth remote control device, which can work within a 75 ft range. When not in use, store the remote control in the slot on the front of the Main Stand.

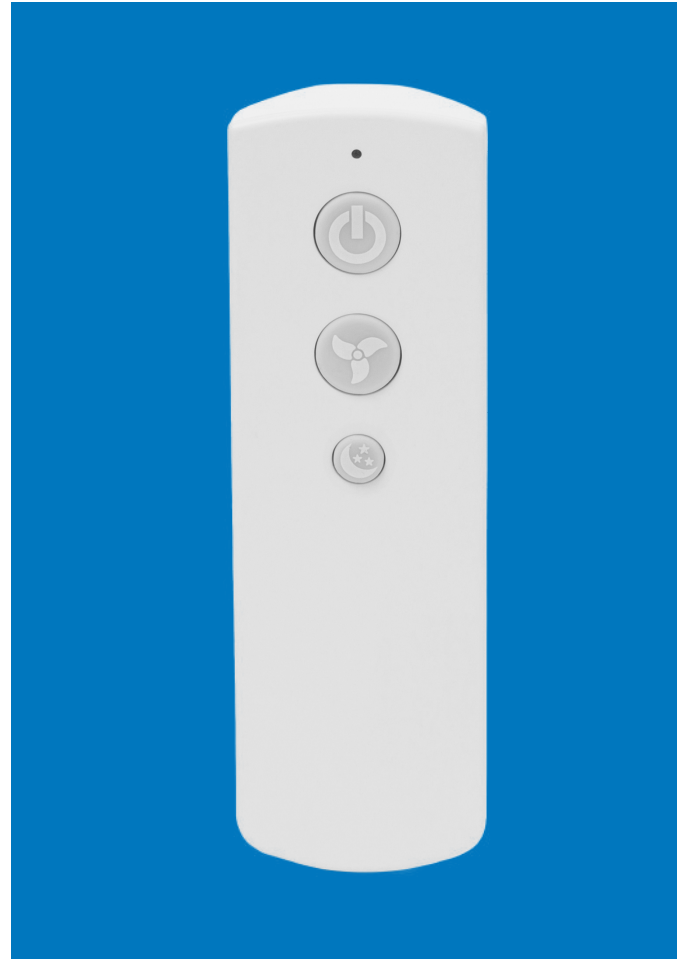

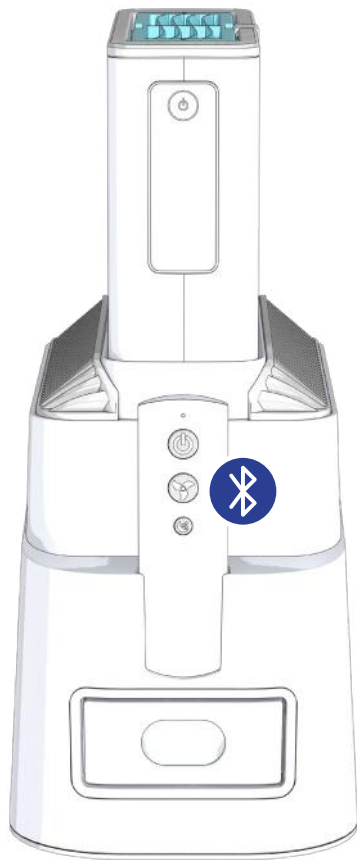

Pair the Remote Control with the Core

1. Install the provided two AAA batteries into the Remote Control.
2. With the SoClean Air Purifier powered on, press and hold the Core power button for 6 seconds. The Core will beep and its power button will begin to flash, indicating that it has entered Bluetooth pairing mode.
3. While the Core is in pairing mode, turn on the Remote Control by pressing its power button. The light on the Remote will flash briefly, indicating that it has also entered Bluetooth pairing mode.

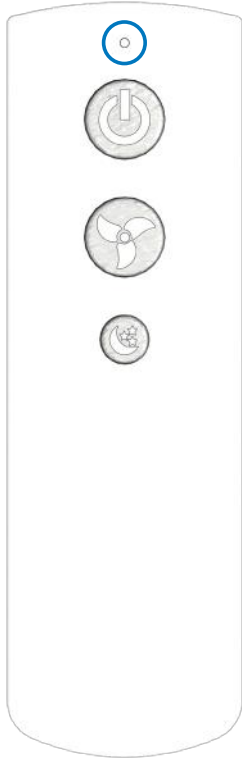

4. After 6 seconds, both the Core and the Remote Control light will stop flashing. The two are now paired.

The Remote Control will stay paired to the Core as long as it has power.

Note: If the Remote Control is not paired properly, the light will blink. Please try again.

Troubleshooting:

If you have problems with pairing your Remote Control, please visit SoClean.com/air-user-manual or call us at 866-501-3705

Remote Control Settings

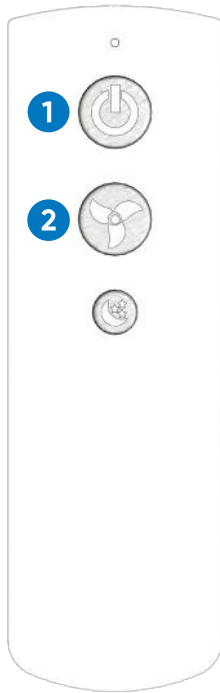

You can control the SoClean Air Purifier settings from:

- The control panel on the Core
- The Remote Control

1. POWER BUTTON





Turns the SoClean Air Purifier on and off.

2. FAN SPEED BUTTON

To select the fan speed you desire, lightly press the fan speed button on the control panel or Remote Control to cycle through the speed settings.

The SoClean Air Purifier operates at four fan speeds, so you can adjust the speed to best meet your needs.

While different fan speeds will either increase or decrease the rate of air flow, the purity of the air generated by the device remains the same at all speeds. Fan speeds 1 & 2 are recommended for use while you're in the room for pure air generated as quietly as possible, while speeds 3 & 4 are intended for use in unoccupied rooms for the fastest air flow.

FAN SPEED	AIR PURIFICATION AND NOISE LEVEL
Background Mode: Typically used while you are in the room	
Speed 1 	Ideal for desk-side use or other quiet settings
Speed 2 	Perfect white noise level for sleep
Turbo Mode: Typically used while you are not in the room	
Speed 3 	Faster rate of air flow
Speed 4 	Fastest rate of air flow

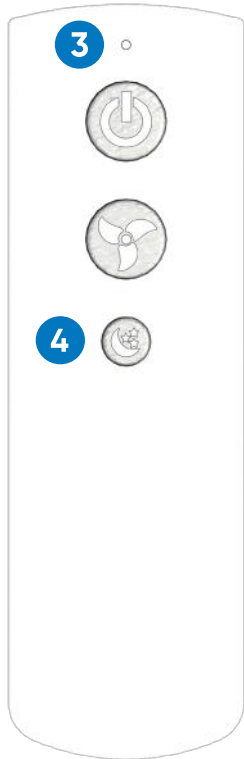

3. INDICATOR

With functioning AAA batteries, the indicator will illuminate with each press of a button on the Remote Control. The light also flashes during pairing. If the light does not illuminate, please check or change the AAA batteries.

4. NIGHT MODE BUTTON

The night mode button controls the display panel illumination. This option is only accessible via the remote control. To operate the night mode:

1. Press the night mode button on the Remote Control to turn off the display lights.
2. Press the night mode button again to turn the display lights to 100%.
3. Pressing the button a third time will turn the display lights to 50%.

Core Panel Description

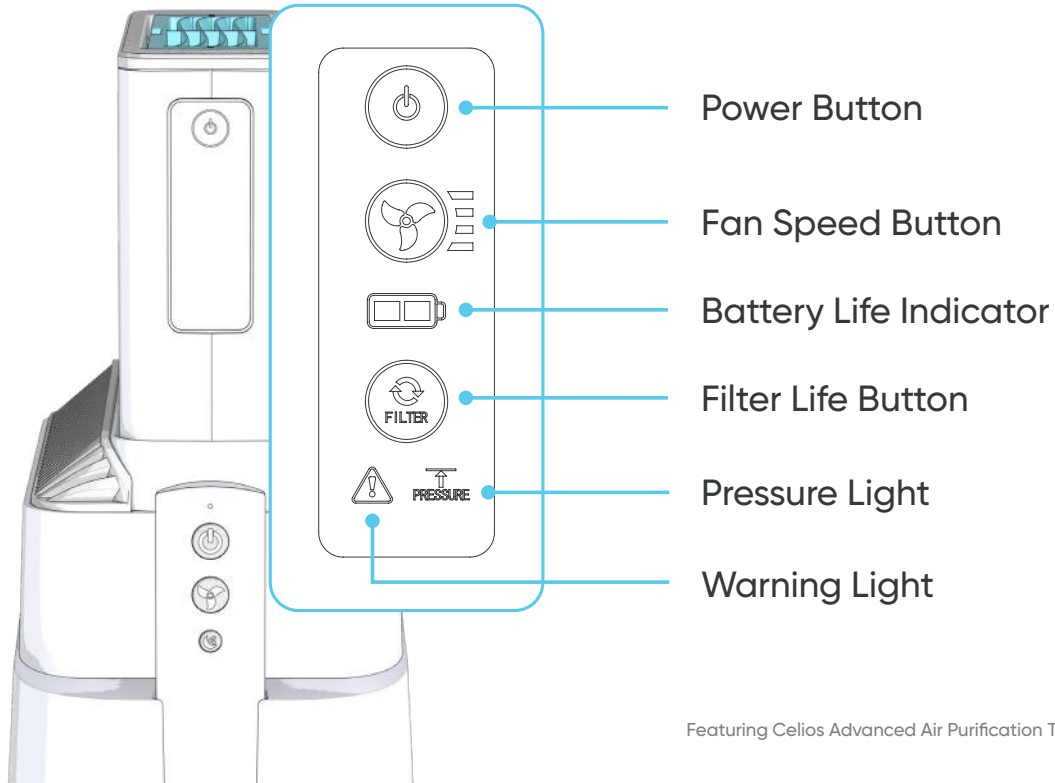

Power Button

Fan Speed Button

Battery Life Indicator

Filter Life Button

Pressure Light

Warning Light

Featuring Celios Advanced Air Purification Technology

Cleaning your SoClean Air Purifier

CLEANING THE SOCLEAN AIR PURIFIER GRILLS

If you notice that the SoClean Air Purifier's airflow is weaker than expected, or if the grey grills on the top of the Main Stand look dirty, then it is time to clean the grills. The grills are magnetically attached and can be removed from the Main Stand and cleaned with soap and water. Allow to dry before replacing.

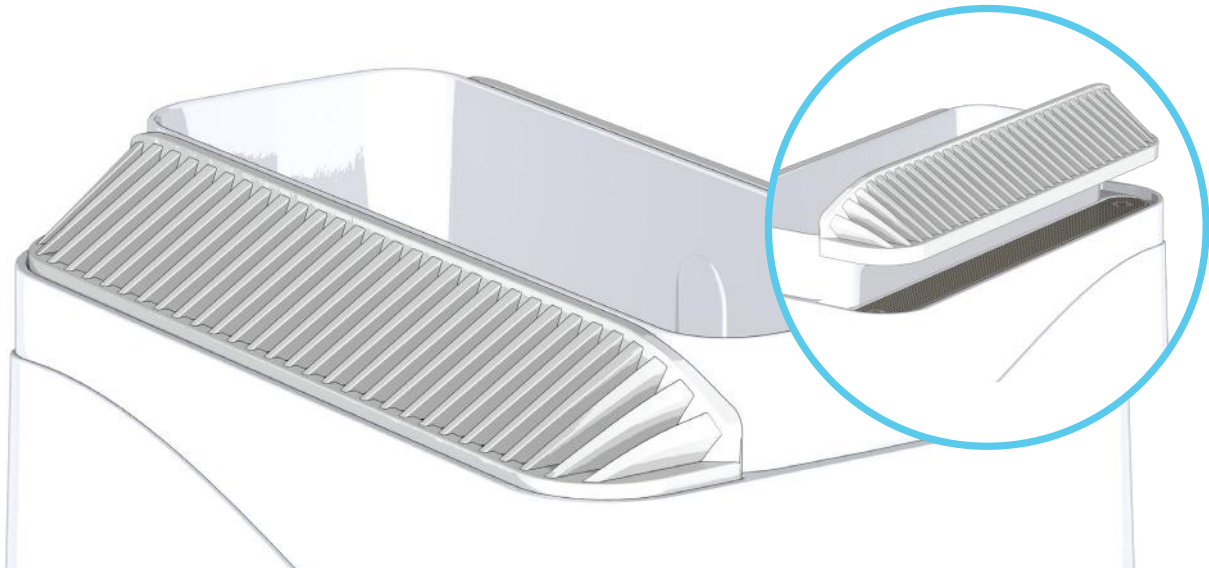



Alarms & Notifications

- When you correctly dock the Core in the Main Stand with power, the unit will beep.
- When you install the first battery (partially or fully charged), the SoClean Air Purifier will beep to let you know that the battery is installed correctly.
- If the SoClean Air Purifier becomes blocked and there is no airflow, an alarm will sound.
- If the Core Filter is missing, not seated properly or has become saturated with filtered contaminants, an alarm will sound.

Under normal use (12 hours/day): The Pre Filter and Carbon Filter should be changed every 4 months, while the Core Filter should be changed every 8 months.

Under heavy use: (24 hours/day): The Pre Filter and Carbon Filter should be changed every 2 months, while the Core Filter should be changed every 4 months.

The SoClean Air Purifier LED panel will display an alert when the filters are approaching or due to be changed.

Notification	Filter Life	Steps to Take	Frequency	
			12 hr/day operation	24 hr/day operation
 <p>Filter Life Button is flashing yellow, and the alarm tone beeps every 60 seconds</p>	50%	Replace the Pre filter & Carbon filter (from the Filter Kit), then reset the alarm using a quick press of the Filter Life Button. The alarm tone will stop and a solid yellow Filter Life Button will remain on.	4 months	2 months
 <p>Filter Life Button is flashing red, and the alarm tone beeps every 60 seconds</p>	20%	Order replacement filter kit if you haven't already, and reset alarm using a quick press of the filter button on the Core Panel. The alarm tone will stop and the solid red light will remain on.	6 months	3 months
 <p>Filter Life Button AND the Warning Light are flashing red, and the alarm tone beeps every 60 seconds</p>	10%	Replace all 3 filters in the device, pre, carbon, and core. Then reset the alarm using a long press on the filter button, about 15 seconds.	8 months	4 months

Troubleshooting

Problem	Possible Cause	Solution
Unit does not power on	<ul style="list-style-type: none"> • Battery(ies) or AC adapter not installed • Battery(ies) installed do not have charge 	<ul style="list-style-type: none"> • Install charged batteries or connect to AC adapter • Replace batteries with charged ones or install AC adapter
Battery should be charging	<ul style="list-style-type: none"> • Battery(ies) is(are) full • No battery(ies) inserted • AC adapter not plugged in • Battery may be at end of life • Battery may be over temperature limit 	<ul style="list-style-type: none"> • The battery light will not display when full and attached to AC adapter • Insert 1 or 2 batteries into either slot • Plug AC adapter into a working outlet • Install new battery and recycle old • Allow the battery(ies) to cool before use
Pressure Light AND Warning Light are illuminated AND Beeping is heard	<ul style="list-style-type: none"> • Core Filter not installed properly • Core Filter is loaded 	<ul style="list-style-type: none"> • Ensure the Core Filter is fully seated and latched into the Core • Remove and discard old Core Filter; install new Core Filter
Unit powered on AND Fan does not operate AND Warning Light flashing	<ul style="list-style-type: none"> • General system error (Warning, Pressure, Beep) 	<ul style="list-style-type: none"> • Remove all power sources; install AC adapter to verify operation; add battery(ies)

Problem	Possible Cause	
Remote will not pair	<ul style="list-style-type: none"> • Error in communications 	<ul style="list-style-type: none"> • Remove batteries in Remote; Pressure Light AND Warning Light are illuminated AND beeping is heard remove all power sources from the Core; reinstall power to the Core then batteries into the Remote; perform pairing sequence again
Flow is reduced but no Pressure Warning Light	<ul style="list-style-type: none"> • Core Filter life is very close to zero 	<ul style="list-style-type: none"> • Replace the Core Filter
Air exiting the Core has an unpleasant smell	<ul style="list-style-type: none"> • Carbon Filter may be depleted 	<ul style="list-style-type: none"> • Replace the Carbon Filter
Core will not fit into the Main Stand	<ul style="list-style-type: none"> • Pre Filter may not be seated fully 	<ul style="list-style-type: none"> • Press the Pre Filter fully into place and install the Back Cover
Unit powers on then immediately powers off	<ul style="list-style-type: none"> • Battery(ies) may be low 	<ul style="list-style-type: none"> • Charge battery(ies) with the supplied AC adapter
Filter Life Button flashing AND Beeping	<ul style="list-style-type: none"> • Filter Life trip point has been met 	<ul style="list-style-type: none"> • Press the Filter Life Button once to silence; Filter Life Button will be solid but no beep

SoClean Air Purifier Warranty

SoClean Inc. warrants this product under this warranty for a two (2) year limited warranty for defects in manufacture or workmanship.

For all warranty issues, a Return Authorization Number and Proof of Purchase is required. Please contact SoClean at info@soclean.com or 866-501-3705 for a Return Authorization Number. CODs are not accepted. Original shipping fees are non-refundable.

Products repaired or replaced under this warranty will not incur re-shipping charges. Under this warranty, the sole remedy shall be repair or replacement at SoClean's discretion. Replacement products may contain new or refurbished parts.

This warranty does not cover product failures due to misuse, abuse, improper maintenance, normal wear and tear, typical required periodic replacement products, or circumstances beyond the control of SoClean. The Product is not designed for or warranted against damage from use in areas subject to extreme temperature, excessive moisture, or other inherently hazardous environments.

IMPORTANT: Please purchase your Filters from SoClean.com/air to ensure authenticity. For purchases from an online marketplace such as Amazon®, please check "sold by SoClean" before making your purchase. Warranties will be voided if the product is used with an inauthentic Filters and not replaced in accordance with usage instructions

LIMITATION DAMAGES: SOCLEAN SHALL NOT BE LIABLE FOR ANY INCIDENTAL OR CONSEQUENTIAL DAMAGES FOR BREACH OF ANY EXPRESS OR IMPLIED WARRANTY ON THIS PRODUCT. NO LIABILITY ARISING FROM ITS USE, HOWEVER, CAN BE ACCEPTED BY THE COMPANY, WHO RESERVES THE RIGHT, WITHOUT PRIOR NOTICE, TO ALTER THE SPECIFICATIONS, CONSTRUCTION, OR CONTENT OF ITS EQUIPMENT AT THE COMPANY'S OWN DISCRETION.

SoClean™ AIR PURIFIER

Featuring Celios® Advanced Air Purification Technology

CUSTOMER SUPPORT

If you have any questions about your SoClean Air Purifier, visit [SoClean.com/air-user-manual](https://www.soclean.com/air-user-manual) or contact us by phone or email:

866-501-3705 | info@soclean.com

Manufactured for:

SoClean Inc.

12 Vose Farm Road, Peterborough, NH 03458

For patent information visit [SoClean.com/patents](https://www.soclean.com/patents)

A000849-11 Rev C 011221

C000850 Rev C

